



WARNING

Improper installation may cause the product to fall, leading to damage or injury. Follow these steps carefully.

1

To open the Clario® dispenser cover, press the button at top to release the cover. Use the key if the dispenser is locked. Turn the key CCW to unlock.

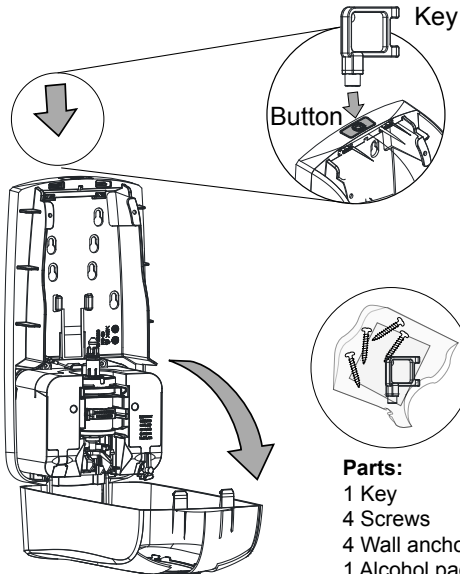

2

Hang the dispenser a minimum of 8 inches above all surfaces. ADA requires dispenser be mounted no more than 48" from ground.

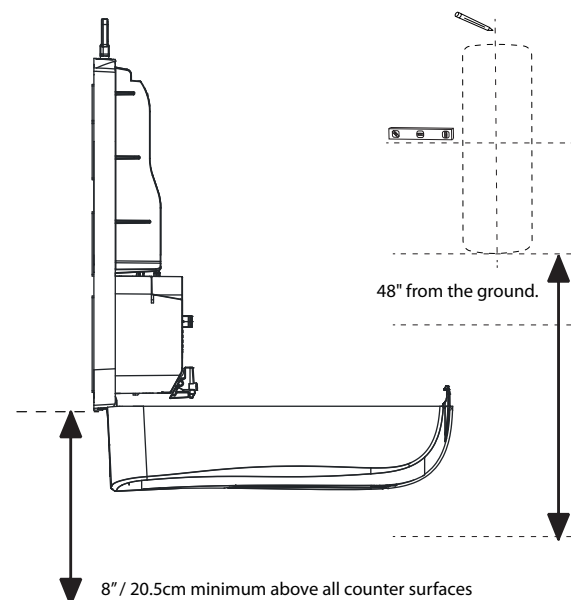

3a

Mount with (4) anchors and screws in 3/16" drill holes using backplate as template.

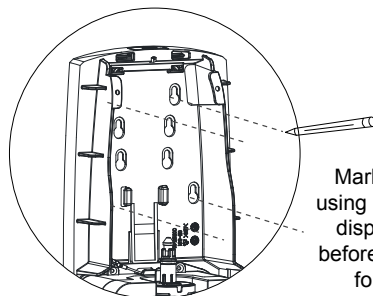
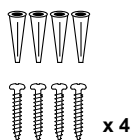

Mark with pencil using your choice of dispenser holes before drilling holes for anchors.

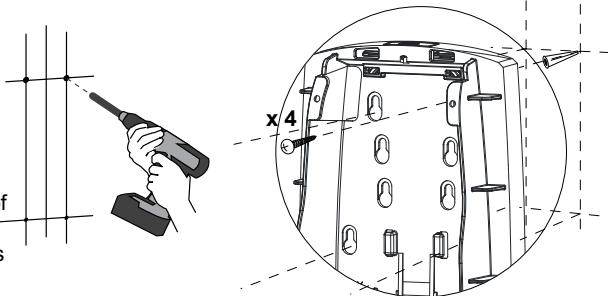

3b

Mount with tape.

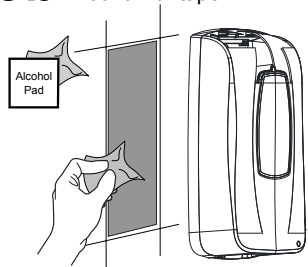

Clean surface



Dry surface



Remove tape backing

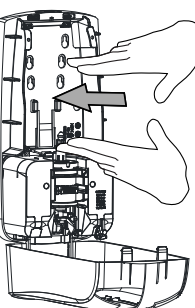
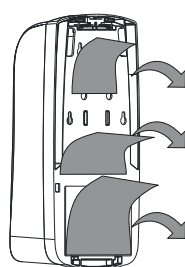

Press firmly

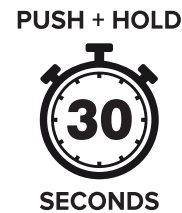

*Allow up to 24 hours for backing tape to fully adhere before loading refill.

4

Remove retainer clip (A) and pump (B) DO NOT DISCARD!

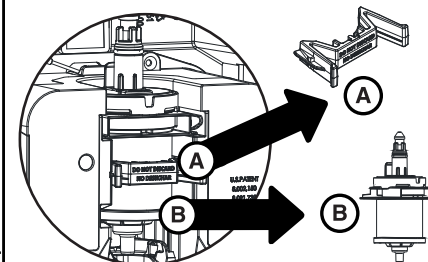

Push and hold tab (C) to release battery cover (D) and open by pulling towards the front. Install included 4D Alkaline batteries then close cover (D) until it clicks. Reinstall pump (B) and retainer clip (A).

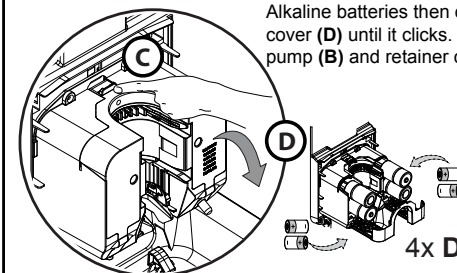

- 5** Push refill bag opening onto top of pump adapter post and push all the way down until fully seated and valve in refill bag opens.

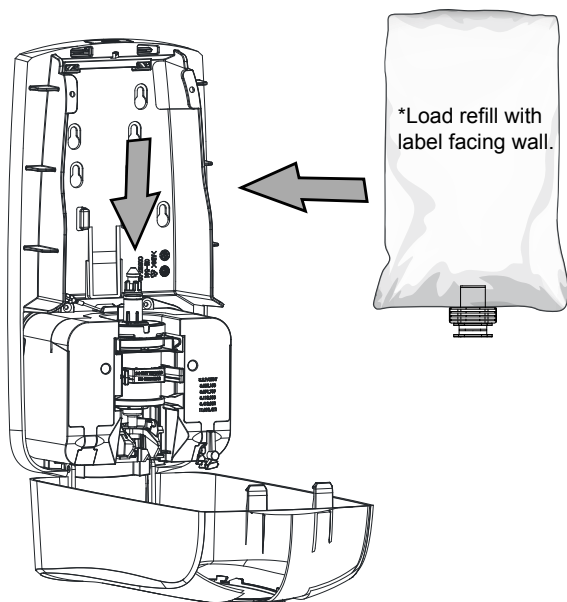

- 6** Ensure edges of refill bag are fully inserted into dispenser body and does not pinch bag when closing.

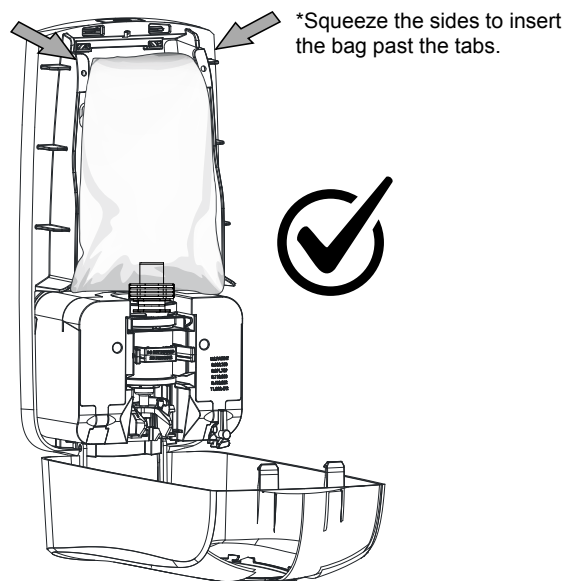

- 7** Pump should stay in dispenser between refills. To adjust dosage size, remove retainer clip **(A)** and pump **(B)** then slide the dose adjuster with a pen or small flat head screwdriver to the desired setting:
- Low/Left = 0.5ml
 - Medium/Middle = 1.0ml
 - High/Right = 1.5ml
- Then replace pump **(B)** and retainer clip **(A)**. Do not discard clip.

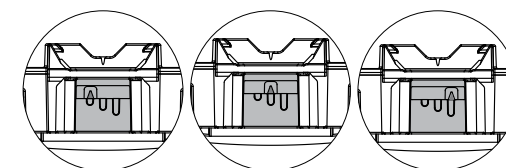
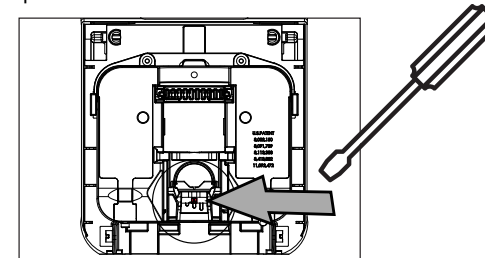

Low

Medium

High

- 8** Close dispenser cover and activate until product dispenses to ensure pump is primed.

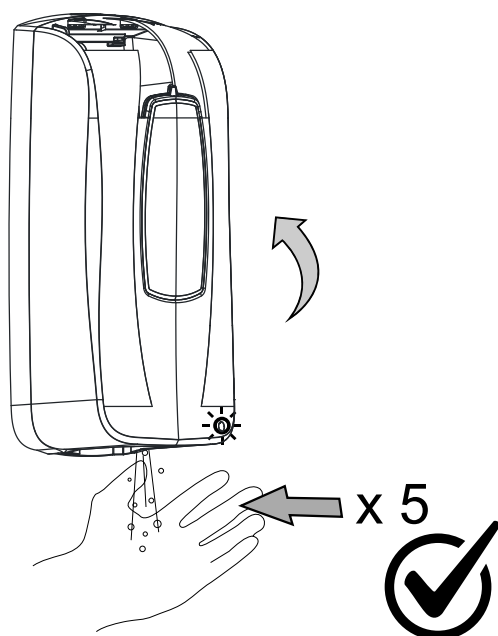

Cleaning and Maintenance

Clean exterior surfaces of the dispenser using warm water and mild soap. DO NOT USE ABRASIVE CLEANSERS. Dry with a soft cloth.

L.E.D. Light Meaning

1. Solid Red = Cover Open
2. Green = In Use
3. Flashing Red = Low Battery

Cautions

1. It is the installer's responsibility to ensure installation of unit complies with all applicable codes, standards and regulatory requirements.
2. Do not install this dispenser above heat sources or near sources of ignition/flame.
3. Do not install where a failure of the mounting system or dripping of product from hands may cause damage to equipment or create a potential safety hazard.

CLARIO® **CB**
TOUCH FREE

Premium Design, Practical Savings.

2025 Betco® Corporation
All Rights Reserved
Betco Corporation
400 Van Camp
Bowling Green, OH 43402
1-888-GO-BETCO (888-462-3826) · Betco.com